

Satisfy the pressure equipment directive 97/23/EG up to category III, module H.

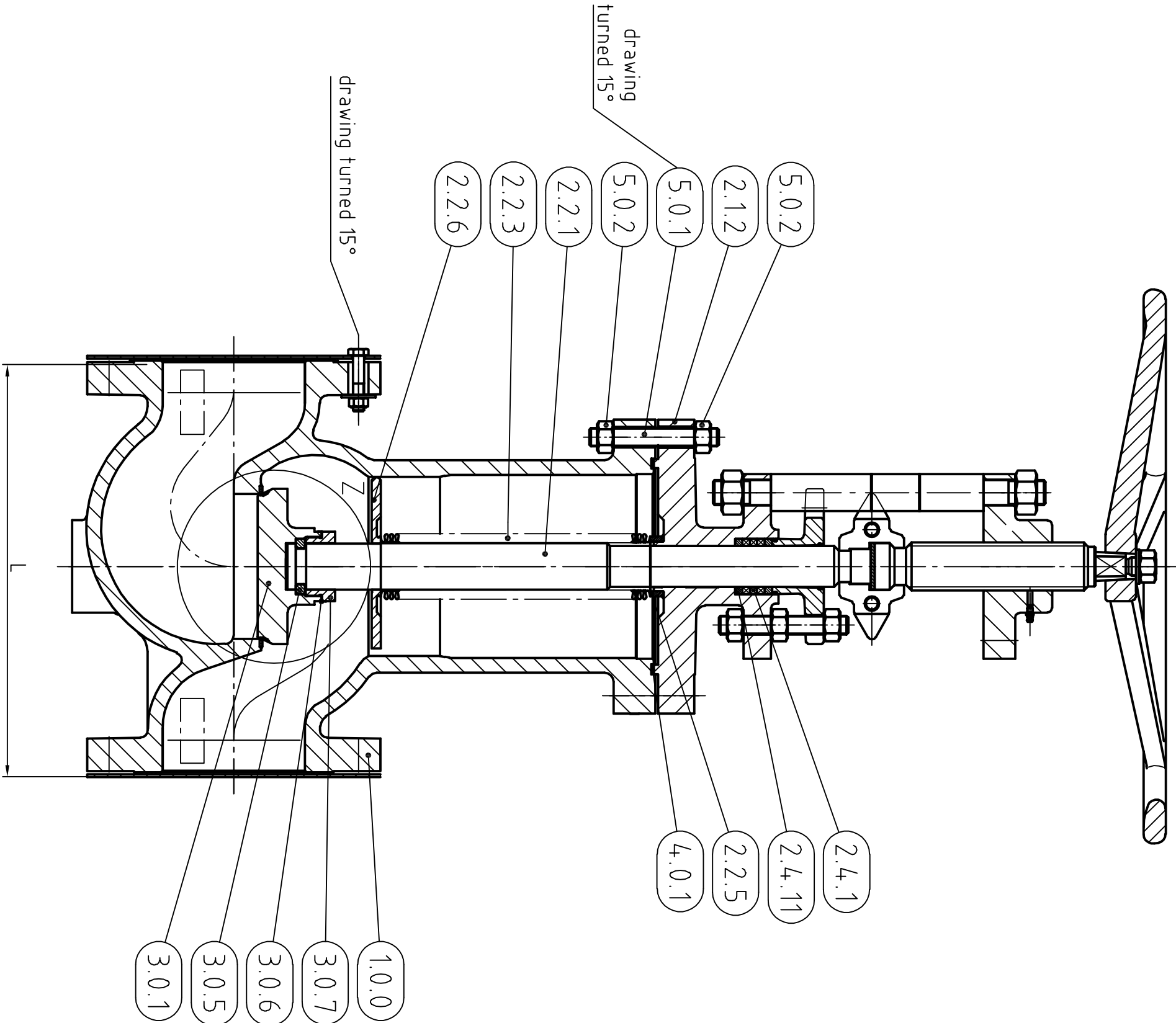

BSG-VALVE PN 16/40	
Size *	Length L
DN15	130
DN20	150
DN25	160
DN40	200
DN50	230
DN80	310
DN100	350
DN125	400
DN150	480
DN200	600
DN250	730
DN300	850
DN350	980
DN400	1100

BSG-VALVE-GVF Class 300	
Size *	Length L
1/2"	152
3/4"	178
1"	203
1.5"	229
2"	267
3"	318
4"	356
5"	400
6"	444
8"	559
10"	622
12"	711
14"	980
16"	1100

BSG-VALVE-BVF Class 300	
Size *	Length L
1/2"	140
3/4"	152
1"	165
1.5"	190
2"	216
3"	282
4"	305
6"	403

BSG-VALVE-GVF Class 150	
Size *	Length L
1/2"	152
3/4"	178
1"	127
1.5"	165
2"	203
3"	241
4"	292
5"	356
6"	406
8"	495
10"	622
12"	698

* DN25-DN150/1"-6" Approved under GEST 17/492

		Standard	alternative materials *	Standard *	alternative materials *	Standard *	alternative materials *
1.0.0	Body	1.6220/LCB/LCC	LC1 LF2	1.4408/CF8M	Hastelloy C276/2.4819 A995 Grade 4A/1.4470 CF3M 1.4404 1.4571	1.0619/WCB/WCC	1.0460
		Seat Stellite 21	Seat Stellite 21	Seat Stellite 21	Seat hardfaced	Seat Stellite 21	Seat Stellite 21
2.1.2	Bonnet	1.6220/LCB/LCC	1.0566 LC1 LF2	1.4408/CF8M	1.4401 Hastelloy C-276/2.4819 A995 Grade 4A/1.4470 CF3M 1.4404 1.4571	1.0619/WCB/WCC	1.0460
2.2.1	Stem lower part	1.4571	2.4819	1.4571	2.4819	1.4571	2.4819
2.2.3	Bellows	2.4819	1.4571 2.4856	2.4819	1.4571 2.4856	2.4819	1.4571 2.4856
2.2.5	Bellows Connection Parts	2.4819	1.4571	2.4819	1.4571	2.4819	1.4571
2.2.6							
2.4.1 (2.4.11)	Gland Packing	PTFE	Graphit	PTFE	Graphit	PTFE	Graphit
3.0.1 3.0.5 3.0.6 3.0.7	Plug	1.4571	1.6220 (1.0566) 2.4819	1.6220 (1.0566)	2.4819	2.4819	
		hardfaced with Stellite 6	hardfaced with Stellite 6 all plugs are softsealed	hardfaced with Stellite 6	hardfaced with Stellite 6 all plugs are softsealed	hardfaced with Stellite 6	all plugs are softsealed available
4.0.1	Gasket	1.4571/PTFE	2.4819/PTFE 1.4571/Graphit 2.4819/Graphit	1.4571/PTFE	1.4571/Graphit	1.4571/PTFE	1.4571/Graphit
5.0.1	Stud Bolts	A 320 Grade L7M - OC	DIN976 1.7225 GC OC A 193 Grade B7 - OC DIN 976 A4 - 70	A 320 Grade L7M - OC	DIN976 1.7225 GC OC A 193 Grade B7 - OC DIN 976 A4 - 70	A 320 Grade L7M - OC	DIN976 1.7225 GC OC A 193 Grade B7 - OC DIN 976 A4 - 70
5.0.2	Nuts	A 194 Grade 7 - OC A 194 Grade 7M - OC	EN ISO 4032 1.7218/KG OC A 194 Grade 2 H - OC DIN 934 A4 - 70	A 194 Grade 7 - OC A 194 Grade 7M - OC	EN ISO 4032 1.7218/KG OC A 194 Grade 2 H - OC DIN 934 A4 - 70	A 194 Grade 7 - OC A 194 Grade 7M - OC	EN ISO 4032 1.7218/KG OC A 194 Grade 2 H - OC DIN 934 A4 - 70

* alternative materials of construction not covered by GEST 17/492

Plug sealing design:
conical design

Z 1:2.5

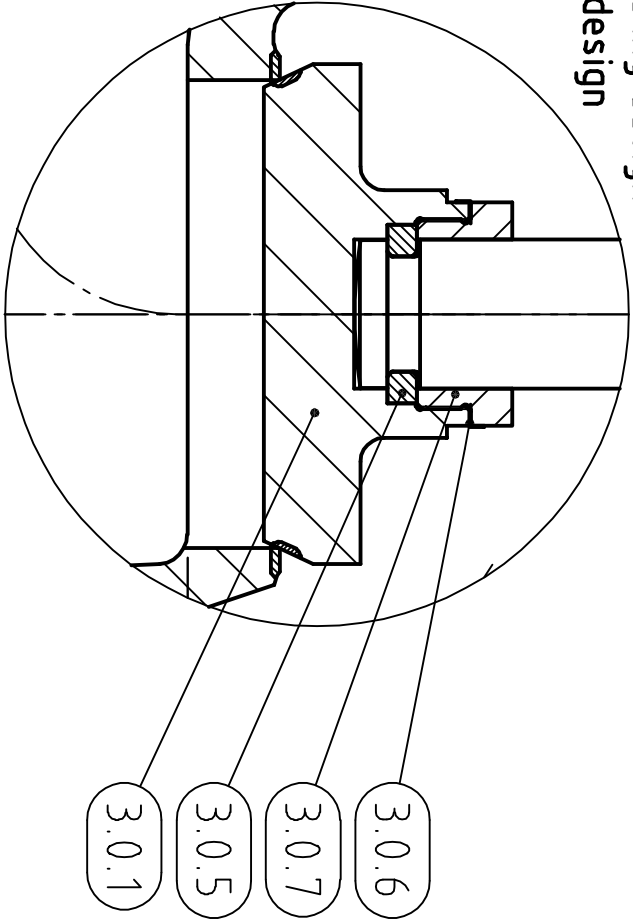

Plug sealing design:
flat design, softsealed

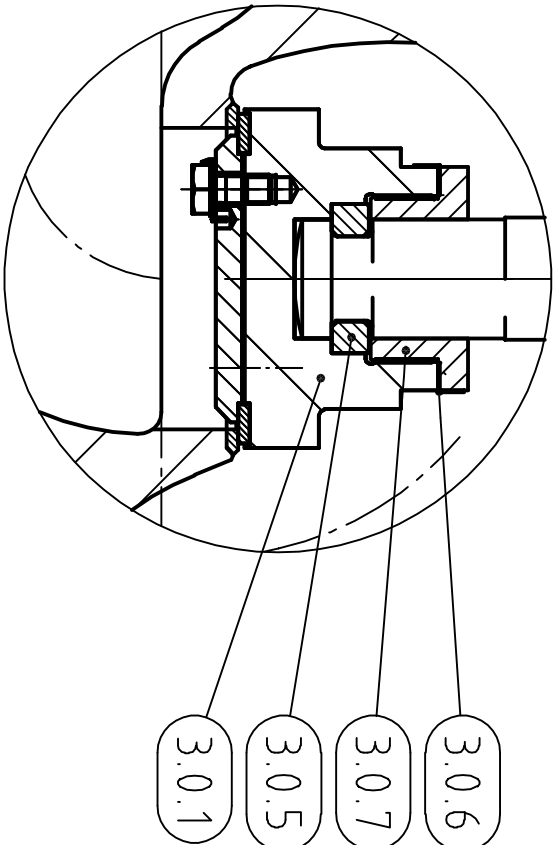

Applicable Standards und Specifications	
WTA Specifications:	Q7.1 (OSV130) as per GEST 17/492 Q8.1 (OSV130) as per GEST 17/492
BSG-Valve PN16/40	
Face to Face:	EN 558 - FTF 1
Flanges:	EN 1092-1
BSG-Valve-GVF Class 300	
Rating:	ASME B16.34 Class 300
Face to Face:	ASME B16.10 Table 2 Col. 15
Flanges:	ASME B16.5 Class 300
BSG-Valve-BVF Class 300	
Rating:	ASME B16.34 Class 300
Face to Face:	ASME B16.10 Table 2 Col. 7 and 8
Flanges:	ASME B16.5 Class 300
BSG-Valve-GVF Class 150	
Rating:	ASME B16.34 Class 150
Face to Face:	ASME B16.10 Table 1 Col. 15
Flanges:	ASME B16.5 Class 150
BSG-Valve-BVF Class 150	
Rating:	ASME B16.34 Class 150
Face to Face:	ASME B16.10 Table 1 Col. 18
Flanges:	ASME B16.5 Class 150

02	Changed from 06/318 to GEST 17/492	12.03.2021	VNell
01	Table Class150 BVF deleted, other tables revised	20.02.2020	VNell
Index: Änderung/Revision			

Bellows Sealed Globe Valve		Sealing surface inlet: EN 1092/ASME B16.5	
ECH35 G-FL DMS - DN640 PN16/40		Sealing surface outlet: EN 1092/ASME B16.5	
ECH35 G-FL 1/2" - 16" Class 300 GVF/BVF and Class 50 GVF		Handwheel	
Signed 15.03.2017		Date	
Checked 15.03.2017		VNEll	
Customer:		Handwheel	
Order-number:			
Drawing-number:		Scale	
85731 Rev. 02		15	
W.T.A. / XOMOX		All rights reserved acc. to DIN 33	
Ver.-Drawing Str.-S			
88131 Lindau			