

DN40 PN25 - ANGLE VALVE - R10250

PISTON ACTUATOR

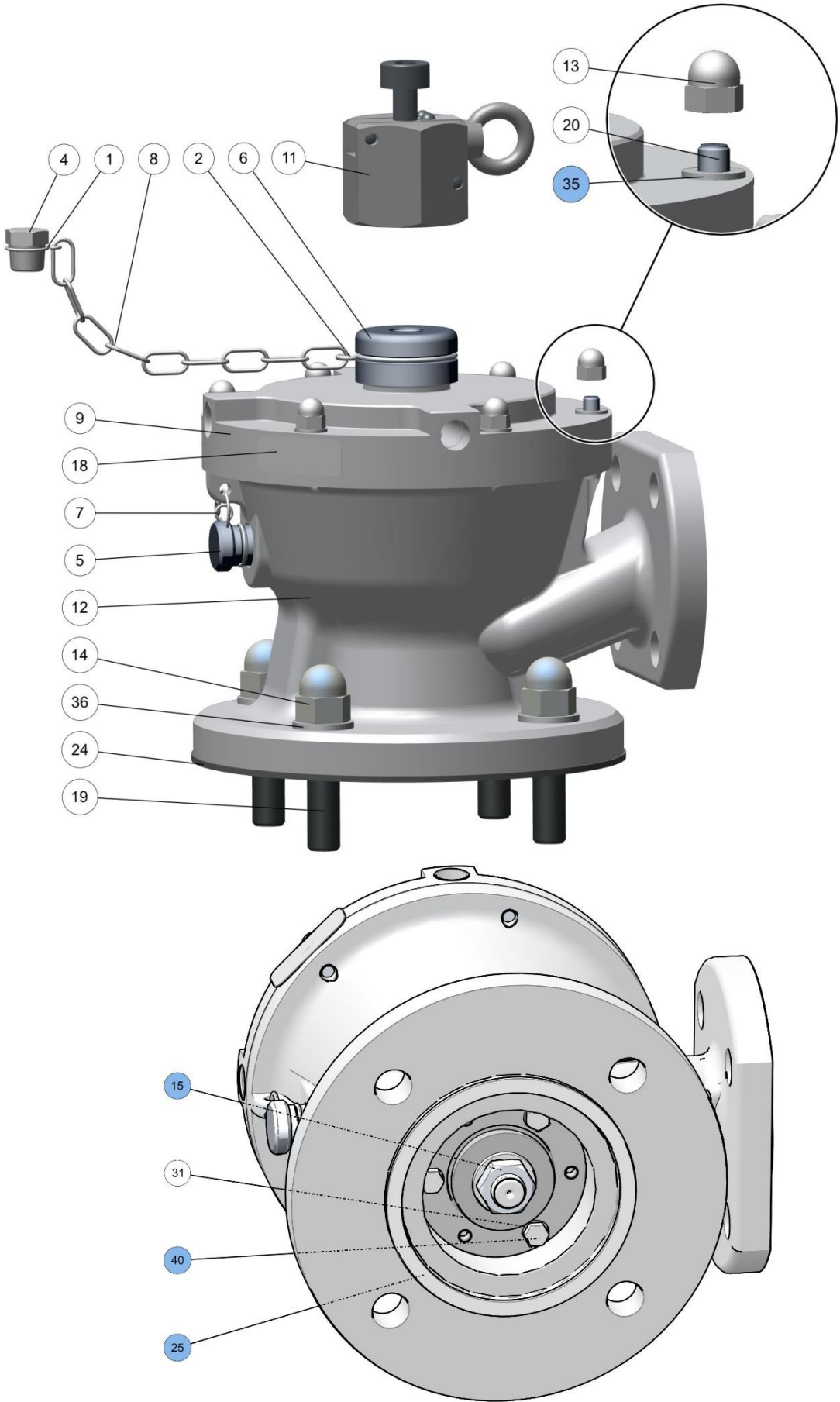
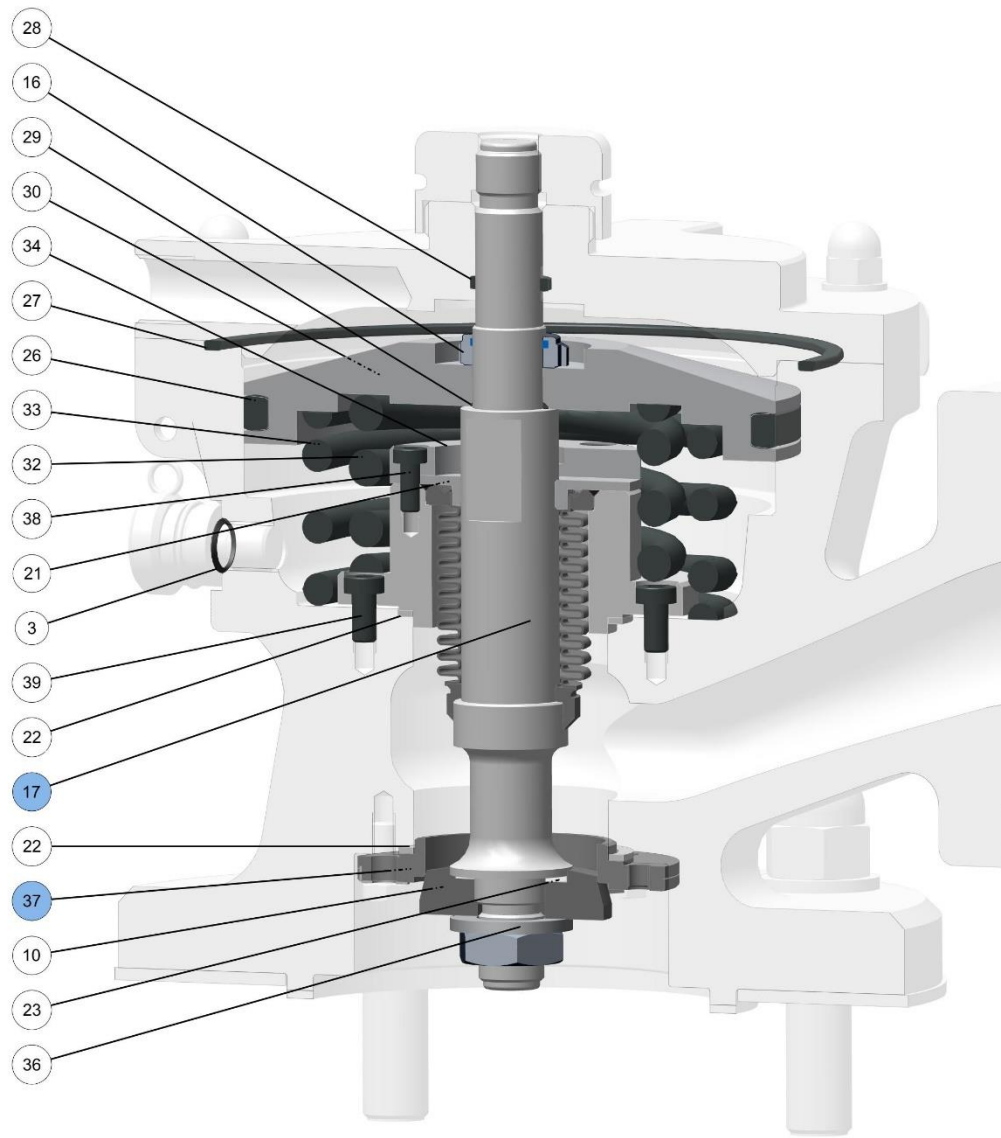

Service pressure	25 Bar	Nominal diameter	Ø 40mm
Test Pressure	37,5 Bar	According to	GEST 75/46
Operating Temperature	-40°C / +50°C	Drawing version	AC

Rep	Designation	Standard material	Optional material upgrade
1	Chain fastener	Steel C70E + Z (NF EN 10270-1)	
2	Chain fastener	Steel C70E + Z (NF EN 10270-1)	
3	O'ring	NBR	
4	Plug	Steel + Z	
5	Purge plug	11SMn37 + P (NF EN 10087)	
6	Security cap	11SMn37 + P (NF EN 10087)	
7	Chain	Stainless steel	
8	Chain	Stainless steel	
9	Bonnet	ASTM A350 LF2 + P	
10	Disc	Hastelloy® C276	
11	Manual control	Steel + Z	
12	DN40 valve body	G20Mn5 + P (NF EN 10213)	
13	Cover nut M8	25CrMo4 (EN 10083-3)	
14	Cover nut M16	42CrMo4 + Z (NF EN 10269)	
15	Nut Hm M16	Steel + Z	<ul style="list-style-type: none">Hastelloy® C276Monel 400 ASTM B164
16	Nylstop nut	Steel + Z	
17	Stem bellow set	X2CrNiMo17-12-2 (NF EN 10272) & Hastelloy® C276	<ul style="list-style-type: none">Hastelloy® C276Monel 400 ASTM B164 & B127
18	Label	Vinyl	
19	Stud M16-65	ASTM A320 L7M + Z	
20	Stud M8-30	ASTM A320 L7M + Z	
21	Stem guide	Steel C22 + P (NF EN 10083-2)	
22	Gasket	PTFE	
23	Disc gasket	PTFE	
24	Dust protection	Chloroprene	
25	Flange gasket	Supranite® PGAC	<ul style="list-style-type: none">Supranite® PGAC F
26	O'ring	NBR	
27	O'ring	NBR	
28	O'ring	NBR	
29	O'ring	NBR	
30	Piston	Steel C22 + P (NF EN 10083-2)	
31	Stop washer	Stainless steel A4	
32	Spring	54SC6 + P (NFA 35 571)	
33	Spring	54SC6 + P (NFA 35 571)	
34	Anti rotation washer	Steel C35E + P (NF EN 10083)	
35	Washer 16-8-2	Stainless steel A4	<ul style="list-style-type: none">Steel + Z
36	Washer 30-17-3	Steel + Z	
37	Valve seat	X2CrNiMo17-12-2 (NF EN 10088-3)	<ul style="list-style-type: none">Hastelloy® C276Monel 400 ASTM B164Stellite® 21
38	Screw CHC TB M5x12	Steel	
39	Screw CZX M6x12	ASTM A320 L7M + P	
40	Screw H M6x16	Stainless steel A4	<ul style="list-style-type: none">Hastelloy® C276Monel 400 ASTM B164
	+ P = Phosphating	+ Z = Zink plating	+ Ni = Nickel plating